

ScrapLock™



Item# SL-35

A little
prevention
goes a
LONG way

The Commercial SINK Drain Protector that **LOCKS** in place for prevention & savings

- **SAVES** time & money by preventing drain clogs, backups & emergencies
- **REDUCES** grease trap solids collection & can extend pumping services
- **SECURE** solution that “triple locks” in sinks for tamper-proof operation
- **EASY 1-2-3** installation that starts blocking solids & debris immediately

LOCKS
In THE
GROOVE

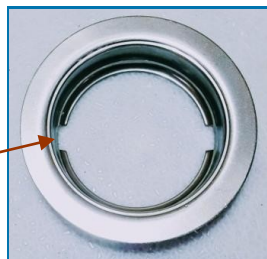

Tamper
PROOF
& easy
Installation



Keep your kitchen **flowing** with **ScrapLock™**



Installation Instructions

Secure sink drain protection with **easy 1-2-3** Installation

Step 1 - Get in the Groove

The ScrapLock uses the ring in the commercial sink drain for a tamper-proof fit. Figure 1 shows the drain ring groove openings of standard sink drain. The “feet” of Scrap-Lock access the two groove openings of the ring.

Step 2 - Twist One Quarter Turn

Once ScrapLock is placed with the feet in ring openings, the guard will be seated flush. Using the set screw as a handle, TURN the guard 1/4 turn (90 degrees) to the right. This secures the feet under ring rim and positions the set screw directly over one of the groove OPENINGS.

*Note: If unable to turn ScrapLock during this step, loosen each “foot” a half-turn to extend height.

Step 3 - Adjust Set Screw & Place Cap

Use the TOOL to tighten down the set screw until the top is recessed slightly into guard. This positions the set screw in the groove opening and **SECURES** the guard in place.

Place small plastic cap supplied into the TOP of the set screw head. This completes the installation process.

Get in the **groove** with **ScrapLock™**

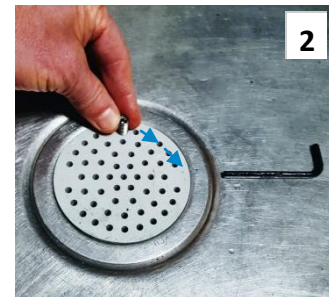
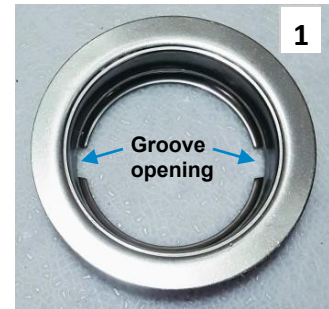

© 2021 All rights reserved. Ecotek LLC

888.855.1925

email: info@earthbio.com

visit: www.earthbio.com