

INSTALLATION INSTRUCTIONS



BAR SINK APPLICATION

Secure **BAR SINK** drain protection
with easy **1-2-3** Installation



Step 1 - Place in the Space and Twist

ScrapLock | **Bar Sink** uses a machined fitting as a base to then lock into with a round head screw. Step 1 begins by placing the fitting into opposing openings in the drain outlet. The “feet” go into the open spaces and then below the metal cross to then TWIST clockwise to secure the base.

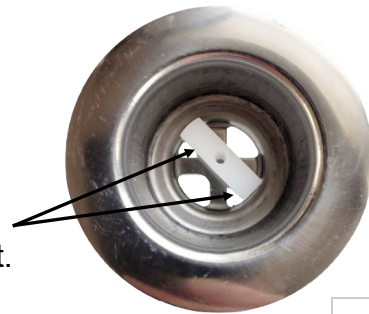

Step 2 - Center Bolt & Start the Thread

Once the ScrapLock fitting is secured as a base, place the drain strainer guard over the top side of the sink drain flange. Then center the 6-32” threaded round head screw into the center hole of the secured base. With fingers, twist the screw until it begins to thread into the base.

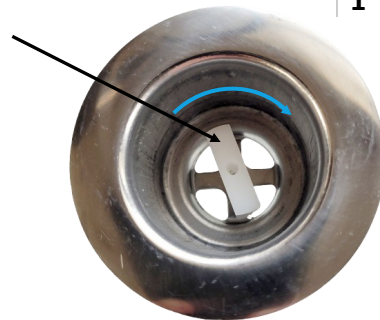

Step 3 - Tighten Screw with L-Key Hex Tool

Use the TOOL to tighten down the screw until the top guard secures into place. Only tighten with tool until snug and be sure not to over tighten. Once the screw is snug the installation is complete. The ScrapLock Bar Sink is ready to strain and protect from solids while cleaner water flows.

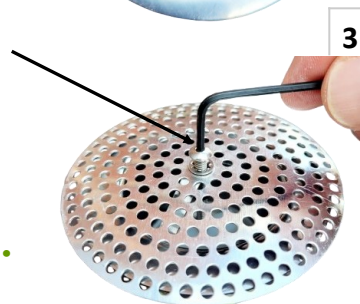
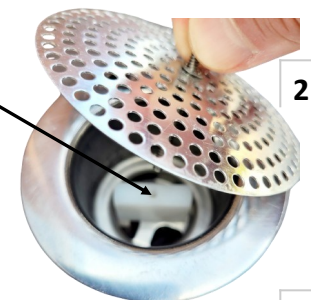

ScrapLock™ ... A BETTER WAY FOR TODAY.

EarthBio
Technologies

© 2024 All rights reserved. Ecotek LLC

888.855.1925 | info@earthbio.com | www.earthbio.com